

### Suzhou Asia Fuji Elevator Co., Ltd.

Add: I-PARK, #88, DONGCHANG ROAD, SIP, SUZHOU, CHINA

P.C: 215000

Tel: 0086-512-67901358

Fax: 0086-512-67903398

E-mail: info@asiafuji-china.com

Https://www.asiafuji-china.com www.asiafujiparts.com

It is a primary information publication. We keep the right of alter the product design and description at any time.  
If there is any dispute out of the literal meaning of any product description, use or quality, the description and alteration of any sales contract, our company will not bear any responsibilities therefrom.  
Because of the restriction of the printing technology if there is any slight difference between the actually machining color and that from this pamphlet, please take the actual material and color sample as the criterion.

# ASIA FUJI

## FREIGHT ELEVATOR SERIES

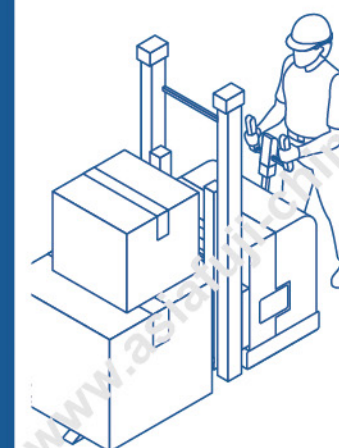

Suzhou Asia Fuji Elevator Co., Ltd.



# Company Profile

Asia Fuji is a company with nearly 3 decades history, specializing in elevator's series business

Elevator series	Residence	Office Building	Hotel	Market	Hospital	Home	Public buildings	Factory
Small machine room passenger elevator	•	•	•	•	•	•	•	•
Machine roomless passenger elevator	•	•	•	•	•	•	•	•
Panoramic elevator	•	•	•	•	•	•	•	•
Home elevator						•		
Hospital elevator					•			
Freight elevator		•	•	•	•			•
Car elevator			•	•	•		•	
Escalator			•	•	•		•	
Moving walk					•		•	



Suzhou Asia Fuji Elevator Co., Ltd is established in the beautiful city Suzhou, we are a professional designer, manufacturer, trader, installer and maintainer of full range of elevator products, such as passenger elevator, panoramic elevator, home elevator, hospital elevator, cargo elevator, escalator and mover.

"Asia Fuji" elevator R&D is in the charge of Asia Fuji Elevator (HK) Ltd, a strategic partner of Japan Fuji エレベーター. As a well-known brand in the world market, "Asia Fuji" elevator has enjoyed a good reputation in domestic and overseas market with its quality&price ratio. Suzhou Asia Fuji Elevator Co., Ltd has its production base in Jiangxi Province, with more than 20 years elevator production experience, high quality production line and standard management system.

As a professional elevator supplier, Suzhou Asia Fuji Elevator Co., Ltd is not only an equipment supplier. From the time of its establishment, we position ourselves at the front line of international competition; actively participate in the marketing with new vision. As to the complicated and high requirement elevator project, we innovate the idea of "elevator packaging solution supply", tailor making the high quality product to meet customers' demands. Suzhou Asia Fuji Elevator Co., Ltd persistently aims to bring superior quality elevator product, excellent service and enhance the purchasing value for customers from all round.



# Smart & Leading Technology

## AC asynchronous geared traction machine

AC asynchronous geared traction machine, which can be repaired on site, is made of high-quality materials and advanced technology, significantly improving transmission efficiency and service life; it is matched with VVVF (Variable Voltage Variable Frequency) intelligent control system, which saves 30% energy and runs more smoothly than the traditional AC dual speed drive system; it is suitable for machine room freight elevator.



## VVVF door operator system

Special motor drive, synchronous belt drive, all rotating parts adopt rolling bearings, special high-performance VVVF control, complete functions and advanced performance; door speed can be set and adjusted according to user's requirements, solid structure, convenient installation and maintenance.

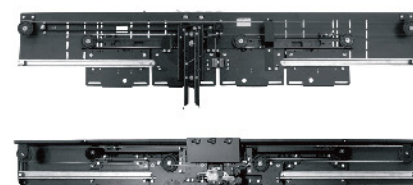

## Light curtain protection

With a sensitive and intensive infrared beam, a safety barrier is built at the elevator entrance. If someone, animal or other object blocks the beam during the elevator closing process, the door closing action will be stopped and the door will be automatically reopened.

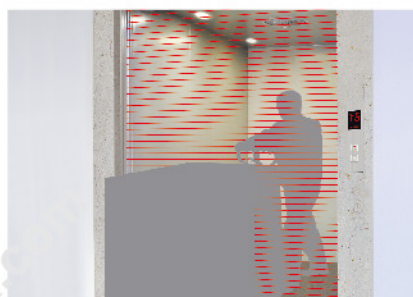

## Energy-saving device

Adopting the world's leading electronic power transformer technology, control technology and graphene supercapacitor technology to collect and store the electric energy emitted by the elevator going down with heavy load as well as going up with light load, and it will be directly used for driving elevator going up with heavy load and going down with light load; the elevator can save 25% to 45% on the basis of the original energy consumption, so that investors can directly benefit from saving electricity expenses.

## Excellent torque characteristics

The most important feature of VVVF speed regulation is its constant torque characteristic. Regardless of light or heavy load, running speed, comfort and leveling accuracy of elevator will not be affected.

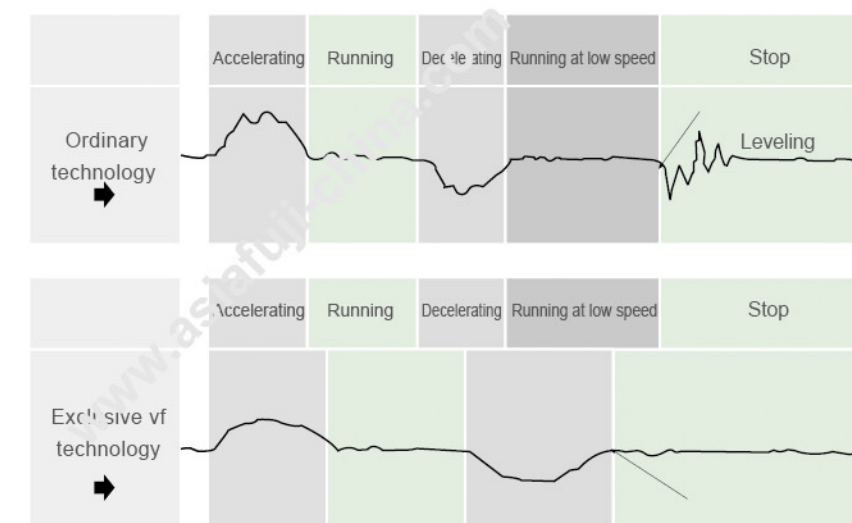

A comparison of accelerating and decelerating curves





# Freight Elevator

## Load goods gently and arrive at destination floor stably

Asia Fuji freight elevator applying of computer-based modular elevator control system, efficient and reliable driving mode, soft and sensitive VVVF door operator system, makes it easy to carry and respond flexibly under various working conditions; high-strength cabin structure, anti-collision bar and light curtain door settings can meet various cargo uses. Meanwhile, different building structures are used to make elevator carry heavy objects like light objects with ease. A new concept of freight transportation is created.

## New generation energy-saving transport pioneer

Asia Fuji machine room-less freight lift applies high-tech permanent magnet gear-less traction machine transmission technology, small host bulk, minimized well space, outstanding energy-saving performance, extremely low running noise, the first-class travel quality that lead the trend of the times.



## Lift car structure-being sturdy and durable

High strength plate bending and forming technology ensures the firm and durable car. In addition, the company specially designs crash barrier to implement multi-protection to the car.



## Highly accurate flat layer - more secure

Leveling accuracy can be controlled within millimeter-sized range.



## Skid-resistance stripe-baseplate-safer

Employing multi-penal cabin doors to reach the maximum width of doors, making it easy for handing large freights.



# Machine Roomless Freight Elevator

Asia Fuji machineroomless freight elevator adopts the high-tech permanent magnetic synchronous gearless traction machine transmission technology that leads the trend of the times. Small size traction machine, minimum shaft space, remarkable energy saving effect, extremely low running noise and first-class riding quality are a combination of safety and technology. It can be widely used in freight transportation places such as factories and shopping malls.

## Energy-saving transportation, a new generation of hercules

### Energy saving

Using synchronous traction machine with low energy consumption to improve operation efficiency and avoid oil pollution

### Smooth operation

Fully closed-loop VVVF drive system is adopted to ensure stable and comfortable start, running and stop of the elevator

### Variety applications

The capacity range is from 1600 kg to 3000 kg, which can meet the different needs of customers.

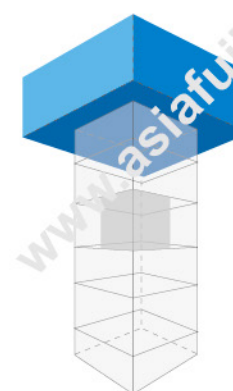

Machine room in the ordinary elevator

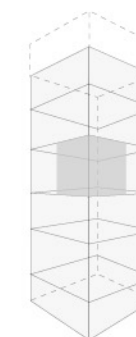

Machine roomless freight elevator



# Car Elevator

## Interpreting an extraordinary riding experience

Asia Fuji series car elevators adopt internationally mature car lifting technology and after absorption, conversion and upgrading, the car elevators were developed and manufactured. The advanced technology eliminates the noise caused by over-load traction system which is brought by uneven force of cabin and the disadvantage causing cabin shaking. It optimizes the features of this series of products.



Dual COP design



Special circuit control and display system



Safety bumper device



Front and rear door are available for elevator cabin



# Dumbwaiter

## Exquisite space, let the "extra" things also enjoy luxury

Asia Fuji series dumbwaiters provide fast, convenient and economical vertical transportation for small freight elevators in various buildings, saving time and human resources. They can be widely used in hotel, restaurant, bank, hospital and other places for transporting goods such as food, tableware, daily necessities and so on.



Floor type (Bi-parking)



Window type (Bi-parking)





# Car Decoration



**SFJ-H001** Standard

Car wall, car door: Painted steel	Sill: Cast iron
Car floor: Checkered plate	COP: Hairline stainless steel
Illumination: Energy-saving fluorescent lamp	
Car ceiling: Painted steel	



**SFJ-H002** Option

Car wall, car door: Painted steel	Sill: Cast iron
Car floor: Checkered plate	COP: Hairline stainless steel
Illumination: Energy-saving fluorescent lamp	
Car ceiling: Painted steel	

# Landing Door Series



Center opening



Side opening



Double-folded center opening type



3-Folded center opening type

## Car collision bar



Wooden



Black rubber

# COP & HOP



SFJ-C101



SFJ-C102



## Floor



Ordinary checkered steel plate I  
(Standard)

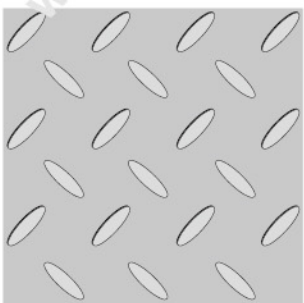

Stainless steel diamond plate II  
(Optional)

## Colour card



Light gray



Cream-colored



Blue



Apple green







The pictures are plotted by computer and are likely somewhat different from the actual products.



# Function Table

## Standard Function

 Running Function	Automatic running	When there is no attendant who operate elevator, elevator will run to the destination floor according to the instruction of passengers automatically.
	Attendant running	Elevator is operated by attendant, attendant press car calls as request of passengers and elevator will run to the destination floor according to the car calls.
	Automatic adjustment of door open holding time	According to current registered landing call and call situation, system will automatically adjust the door open holding time.
	Door re-open at current floor	When door is closing, door can re-opened by pushing landing call button at current floor.
	Car call cancel	If passengers press the wrong floor button in car, same button press it again can cancel the wrong register.
	Parking	When electric key switch is turn off, elevator enters into parking state, it will not serve to any landing call.
 Safety function	Light curtain protection	When light curtain is sheltered, door will stop closing at once and automatically open.
	Overload stop	When elevator is overload, elevator door keeps opening, buzz rings and elevator stops at the current floor.
	Inspection operation	When elevator enters into inspection state, car runs in jog state.
	Troubleshooting	Controller can record faults in memory to facilitate the fault elimination and restore elevator running.
	Auto-landing with fault	When there is any fault occurred in elevator running, when safety circuit is valid, elevator lands to the nearest floor.
	Door close repeat	On normal mode, after running door close command, if door inter-lock circuit isn't connected, elevator opens door and closes it again.
	Top/bottom limit and final limit protection	The devices can prevent elevator from crashing to the top or bottom of hoistway in case that elevator is out of control with fault. It ensures the safety and reliability.
	Down running protection	When elevator runs down in over speed, this device cuts off the control power to stop the motor running, speed limiter is motivated to force elevator to stop and ensure the safety.
	Up running protection	When elevator runs up in over speed, the device forces elevator to decelerate and braking.
 Human-machine Interface	Safety circuit protection	When elevator circuit is closed or contacts are adhered, elevator stops running at once.
	Door interlock protection	Only all doors are completely closed, elevator can run. When door interlock contacts are adhered, elevator stops running at once.
	Main contactor protection	System detects if the main contactor acts reliably, if any abnormal is detected, elevator stops running at once.
	Brake detecting protection	System detects the brake state, if there is any abnormal or braking contacts are adhered, elevator can't start running.
 Human-machine Interface	Micro push button	C.O.P. and H.O.P. both adopts new micro push button.
	Running state display	System can indicates running direction, floor, door state, default ect.
	Non-stop floor set	Set the non-stop floor according to the customer's requirement.
	Homing floor set	Set the homing floor according to the customer's requirement.
	Hoistway self-learning	Through hoistway self-learning, system can measure out the distance between each floor and record them permanently.

 Emergency Function	Emergency lighting	When power is off, car emergency light is on automatically.
	Emergency electric operation	When elevator enters into emergency electric operation state, elevator runs in low speed inching running.
	5-way intercom	Communication between car inner, car top, machine room, pit and security room through intercoms is realized.
	Alarm bell	In emergency situation, pressing the alarm bell button on C.O.P. continuously, alarm bell on car top will ring.
 Energy Saving	Fan& light automatic off	If there is no car call or landing call in a preset time, car inner fan and light will be automatically off.
 Running Function	Door close delay	Pushing the door open button in car can prolong the door open state for a period.
	Fire emergency return	In fire emergency state, all landing calls are eliminated, elevator runs to the preset floor and open door.
	Double door control	By setting, system can control double door's action on corresponding floor.
	Arrival gong	Arrival gong on the car top advises passengers that elevator arrives.
 Human-machine Interface	Sub-C.O.P.	It is for building with crowded passengers, it facilitates passengers to register call.
	IC card control	All (part) of the floor need entry approval, only with IC card can run the elevator.
 Emergency Function	Automatic Rescue Device (ADR)	When power is off, this device supplies power to elevator, elevator runs to the nearest floor, open its door and evacuates the passengers.
 Monitor function	Traction machine monitor	The monitor for machine room less elevator installed on the traction machine top can monitor the traction machine state.

## Optional Function



# Machineroom Freght Elevator Civil Plan

Shaft Vertical Plan

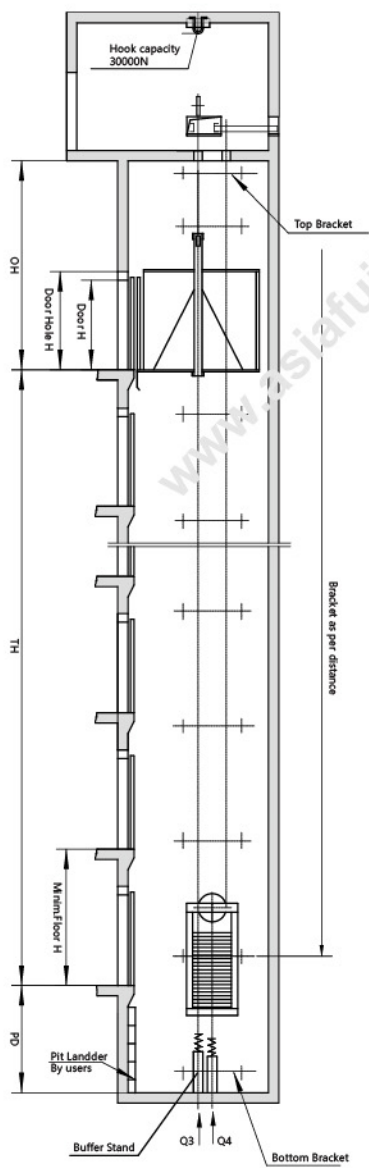

M.R Plan View

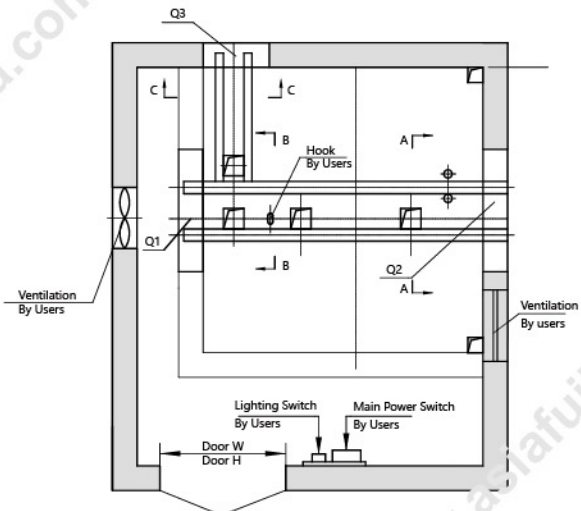

Shaft Plan View

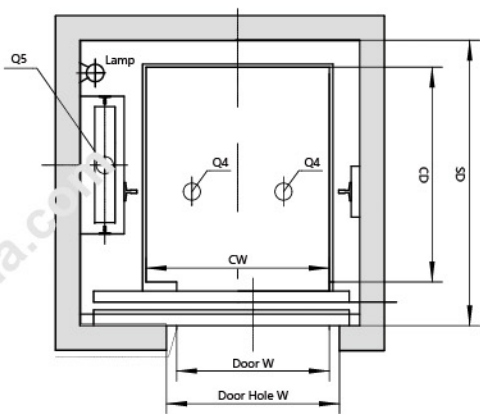

carrying capacity (kg)	m/s	DW × DH(mm)	CW × CD(mm)	HW × HD(mm)	MRW × MRD × MRH(mm)	OH(mm)	PD(mm)	TH(m)	Opening Method
1000	0.5	1200x2100	1400x1700	2250x2200	3000x3500x2500	4200	1400	30	Double-folded side opening
1600	0.5	1500x2100	1700x1950	2650x2450	3500x4000x2500	4500	1500	30	
2000	0.5	1500x2100	1800x2300	2750x2800	3500x4000x2500	4500	1500	30	
3000	0.5	1800x2100	2000x2800	3400x3400	3400x4500x2500	4600	1500	30	Double-folded center opening type
4000	0.25/0.5	2000x2300	2200x3300	3700x3800	3700x3800x2900	5000	1700	30	
5000	0.25/0.5	2400x2400	2400x3600	4000x4100	4000x4100x2900	5000	1700	30	

Note: Only for reference, final manufacture please follow contract.

# Machine Roomless Freight Civil Plan

Shaft right side  
vertical view/1:60

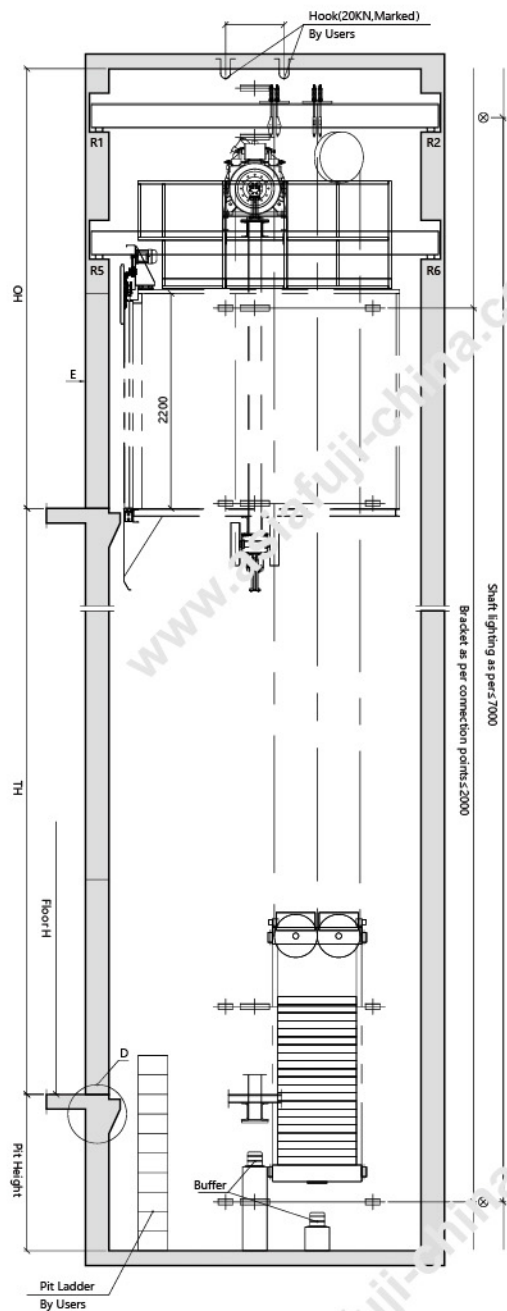

Top Plan View/1:60

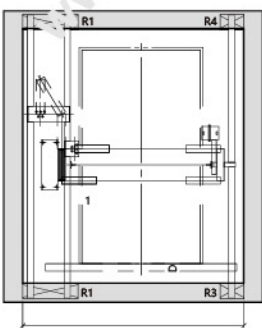

Shaft Plan View/1:60

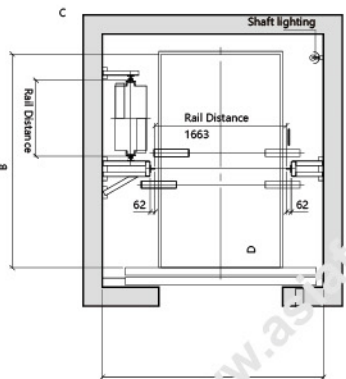

Pit Plan View/1:60

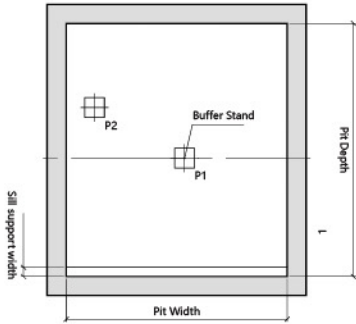

kg	m/s	DW × DH(mm)	CW × CD(mm)	HW × HD(mm)	OH(mm)	PD(mm)	TH(m)	Opening Method
1600	0.5	1500x2100	1700x1950	3000x2850	4700	1600	30	Double-folded center opening type
2000	0.5	1500x2100	1800x2300	3200x3000	4700	1600	30	Double-folded side opening
3000	0.5	2000x2100	2000x2900	3500x3400	4800	1700	30	Double-folded center opening type

Note: Only for reference, final manufacture please follow contract.



Car Elevator Civil Plan

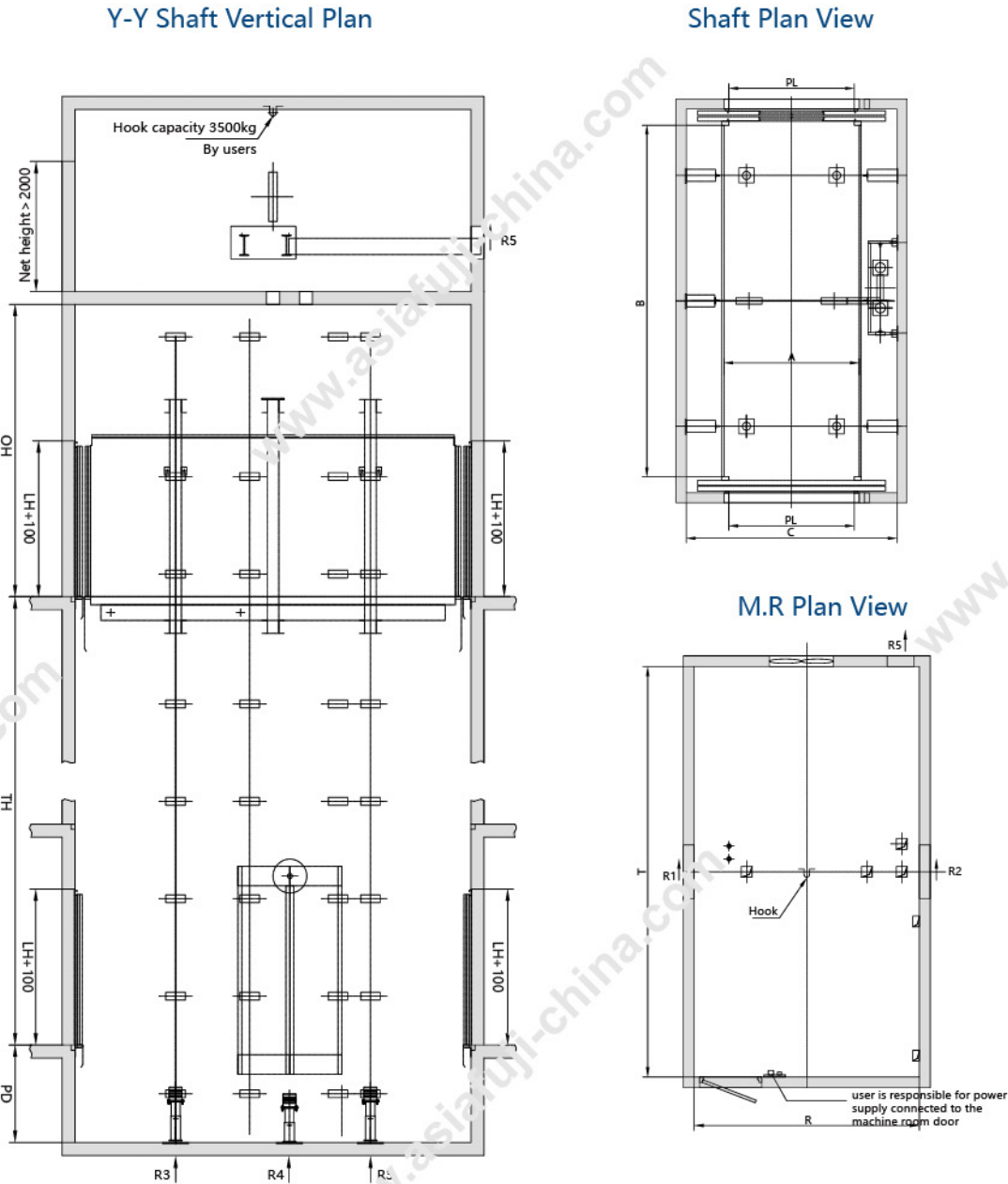

kg	m/s	DW × DH(mm)	CW × CD(mm)	HW × HD(mm)	MRW × MRD × MRH(mm)	OH(mm)	PD(mm)	TH(m)	Opening Method
3000	0.5	2300x2200	2500x5800	4000x6350	4000x6350x2900	5000	1700	30	Double-folded center opening type
4000	0.25/0.5	2400x2200	2900x6000	4300x6550	4300x6550x2900	5000	1700	30	
5000	0.25/0.5	2600x2200	3200x6800	4650x7350	4650x7350x2900	5000	1700	30	

Note: Only for reference, final manufacture please follow contract.

Dumbwaiter Civil Plan

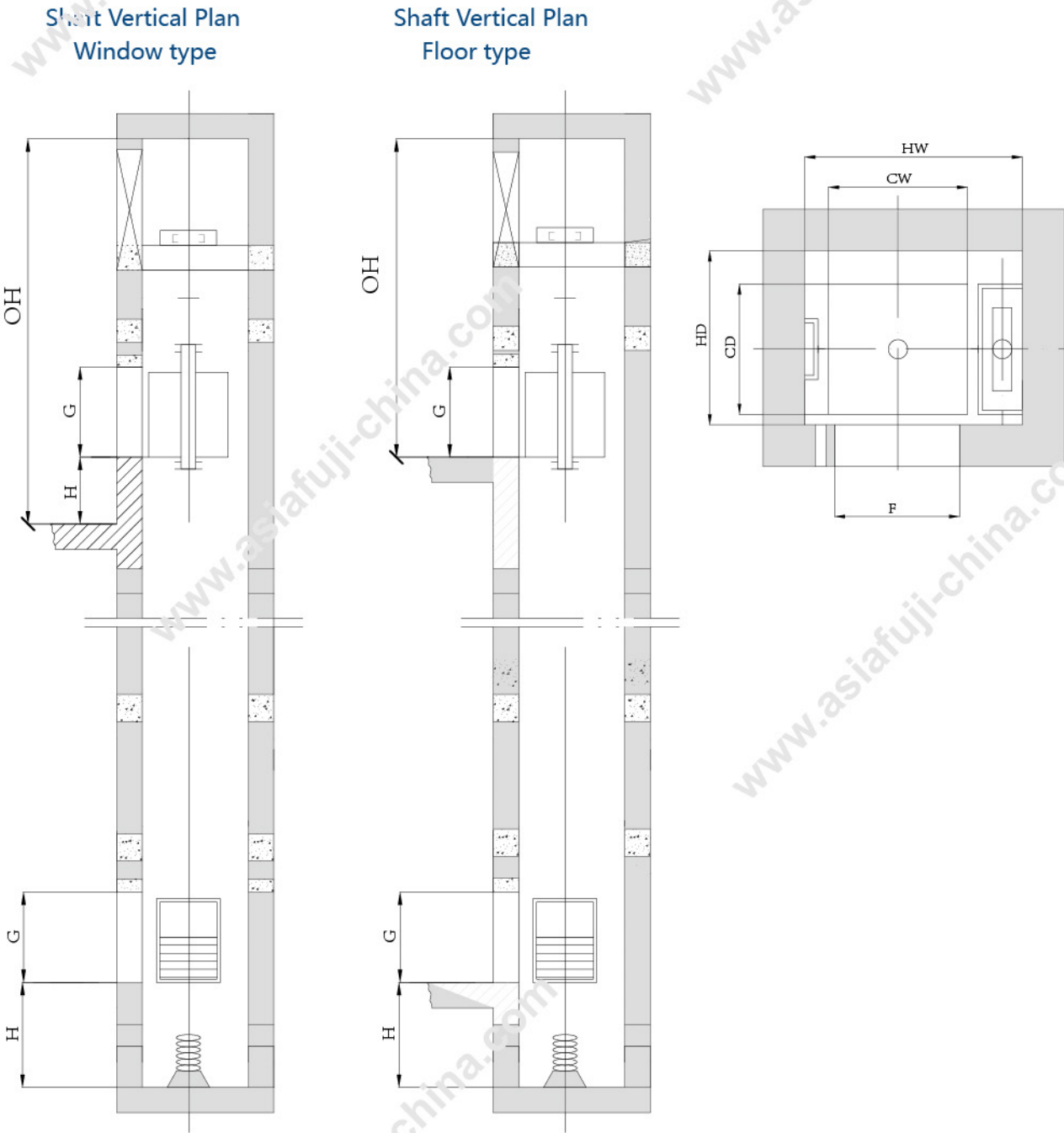

Carrying capacity (kg)	Type	Speed (m/s)	Car size (mm)			Shaft size (mm)		Open type	OH (mm)	Motor power (kw)	Landing door plan (mm)		
			CW	CD	CH	HW	HD				F	G	H
100	Window	0.3	700	700	800	1200	1000	Up-down Straight gate	≥ 3500	0.75	800	900	700
200	Floor	0.4	800	800	1000	1300	1000		≥ 3500	1.1	900	1100	700
250	Window	0.4	900	900	1200	1500	1250		≥ 3200	2.2	1000	1300	800
250	Floor	0.4	1000	1000	1200	1600	1250		≥ 3200	3.0	1100	1300	1000



# After-sale Service



Professional team



Service line



Convenient service



Professional maintenance

## Offering best solution

We firmly believe that superior quality is not the only factor to make a product reach a perfect level. Only with a high-standard service assurance can truly create the maximum value for our customers and customers can indeed enjoy the beyond-value service brought by this product. With the service concept of "ubiquitous service, all for customers", we provide after-sale service guarantee for 24 hours a day, 365 days a year.

Standardization: Globally unified service standard, designed to provide you with professional services

Professionalization: Well-trained service team to provide you with a full range of service solutions

Systematization: Strict and complete service process to ensure perfect service is close to you

Personalization: Hierarchical service scheme, close to your needs, win value for you

